

Dummy Trailer Hitch Instructions (ダミートレーラーヒッチ取り付け説明)

やあ、サーリーのビッグダミートレーラーヒッチを購入いただきありがとうございます。このヒッチはサーリービル&テッドトレーラーのホイールヨークと交換するよう設計されており、ビッグダミーカーゴバイクを使いながらトレーラーを牽引することが出来ます。

⚠警告：サイクリングには危険が伴います。自転車部品はプロの整備士によって組み付け、お手入れを行ってもらって下さい。自転車やアクセサリーの改造は行わないで下さい。全ての製品の説明書、メーカーのウェブサイトに掲載している警告を含む情報に目を通し、従って下さい。乗車の際は常にヘルメットをかぶりましょう。

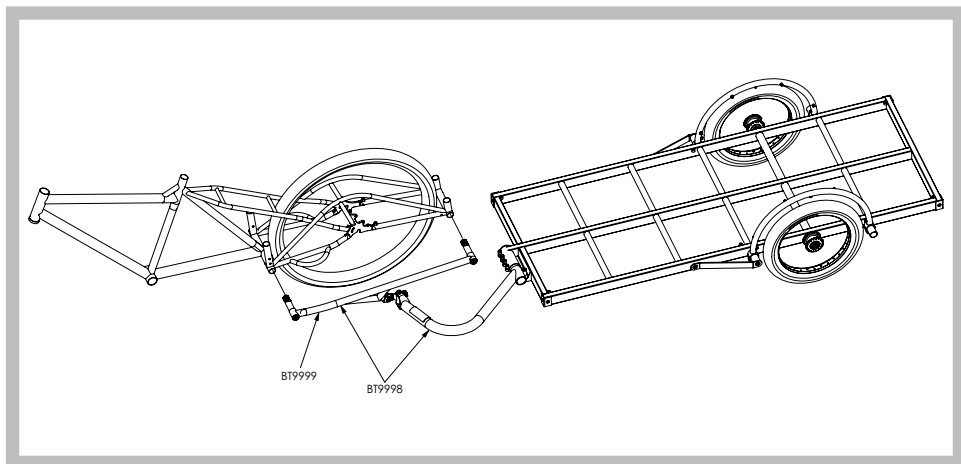

追加製品や安全の情報に関してはウェブサイトのwww.surlybikes.com/safetyをご覧ください。

ダミートレーラーヒッチはお持ちのビッグダミーにビル&テッドトレーラーを取り付けるための連結点を意図された製品であると同時に、再び車を持つ必要性を除外する製品でもあります。そして足を載せるプラットフォームを意図した製品ではありません。

Tools Needed (必要工具)

グリース

- (1) 6mm アーレンキー
- (1) 14mm ボックス、オープンレンチ
- (2) 17mm コーンレンチ

Ongoing Maintenance (使用中のお手入れ)

Periodically check to make sure all bolts are tightened to proper spec and occasionally re-greased.

Limited Warranty (制限保証)

This SURLY product is warranted against defects in materials and workmanship for three years from the date of retail purchase of the product, subject to the limitations detailed below. Save your dated receipt for proof of purchase.

This warranty does NOT cover the following:

- Damage due to improper assembly or follow-up maintenance or lack of skill, competence or experience of the user or assembler
- Products that have been modified, neglected, used in competition or for commercial purposes, misused or abused, involved in accidents or anything other than normal use
- Installation of components, parts or accessories not originally intended for or compatible with bicycle as sold
- Damage or deterioration to the paint, surface finish, aesthetics or appearance of the product
- Normal wear and tear
- Labor required to remove and/or refit and re-adjust the product within the bicycle assembly

This limited warranty is expressly limited to the repair or replacement of a defective product, at the option of SURLY, and is the sole remedy of the warranty. This limited warranty applies only to the original purchaser of the SURLY product and is not transferrable. This warranty applies only to products purchased through an authorized dealer or distributor. In no event shall SURLY be liable for any loss, inconvenience or damage, whether direct, incidental, consequential, or otherwise resulting from breach of any express or implied warranty or condition, of merchantability, fitness for a particular purpose, or otherwise with respect to our products except as set forth herein.

This limited warranty gives the consumer specific legal rights, and those rights and other rights may vary from place to place. This limited warranty does not affect your statutory rights.

TO THE EXTENT NOT PROHIBITED BY LAW, THESE WARRANTIES ARE EXCLUSIVE AND THERE ARE NO OTHER EXPRESS OR IMPLIED WARRANTIES OR CONDITIONS INCLUDING WARRANTIES OR CONDITIONS OF MERCHANTABILITY AND FITNESS FOR A PARTICULAR PURPOSE.

Contact us:

By all means, give us your feedback!

surlly

Phone: 877.743.3191

Web: www.surllybikes.com

E-mail: derby@surllybikes.com

Where We Is: 6400 W. 105th st., Bloomington, Mn 55438 USA